



# Freestanding Bathtub

## BT020057\_L



### SPECIFICATIONS

2000\*850\*580 mm

Water Depth to Overflow: 400mm

Capacity: 449L

Overflow available

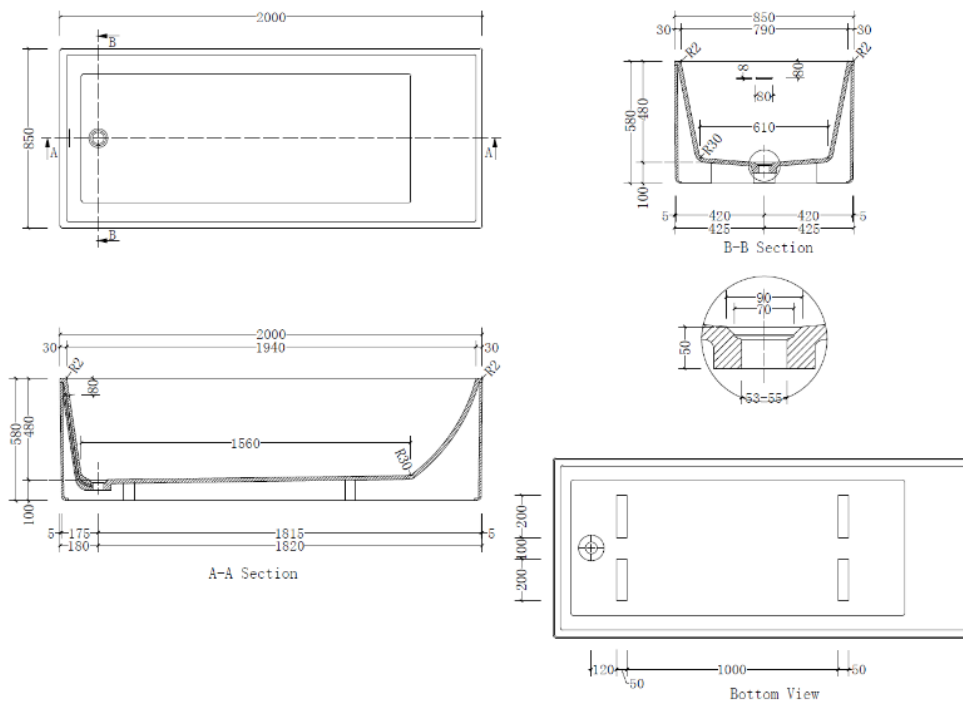

\*Dimensional tolerances are applied to meet design requirements and tailor-made needs for customers.  
 \*All dimensions are subject to the final mutually approved document.