



# Freestanding Bathtub

## BT010022\_A



### SPECIFICATIONS

Ø1450\*560 mm

Water Depth to Overflow: 390mm

Capacity: 465L

Overflow available

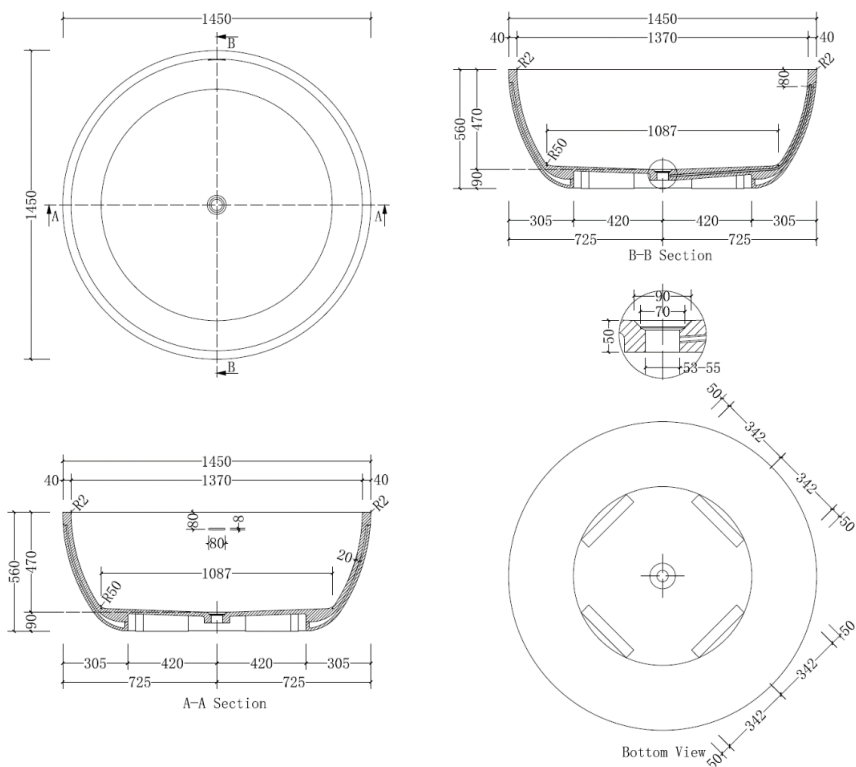

\*Dimensional tolerances are applied to meet design requirements and tailor-made needs for customers.

\*All dimensions are subject to the final mutually approved document.